

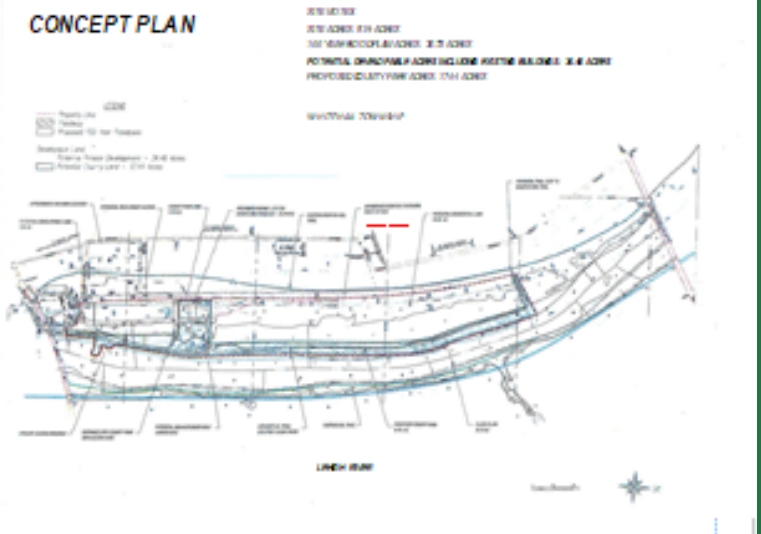

Contact:

Jane Schiff
 SchiffJane@Gmail.com
 C:610-216-5232

CONCEPT PLAN



Excellent Location

The Thomas Point River Property
 3161 E Church Street,
 Whitehall PA. 18052

Now Available!

34.46 Acres of potential Developable
 Acres

Public Water, Sewer and Gas Available

OS-1

Offered at: \$3,400,000

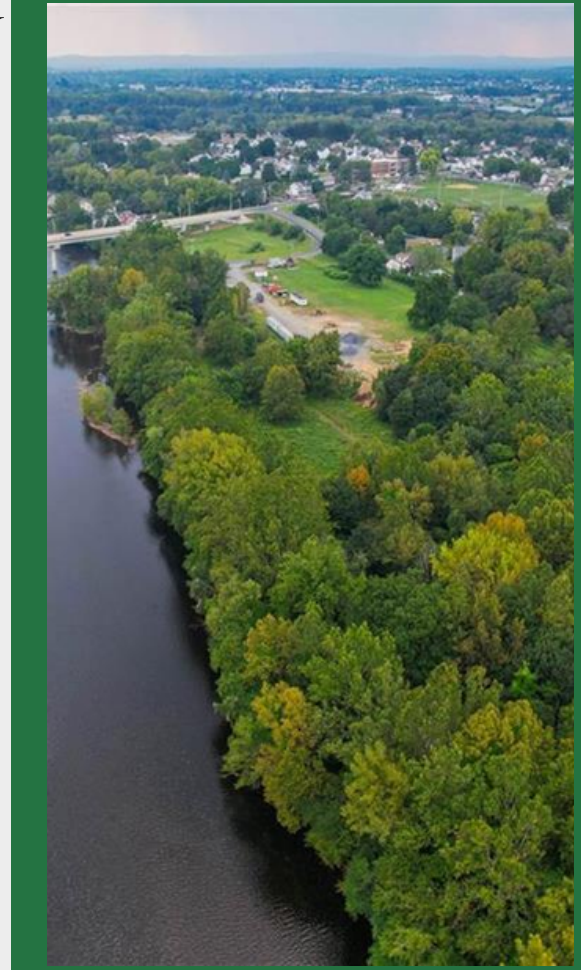

3500 WINCHESTER ROAD, SUITE 201
 ALLENTOWN PA, 18104 .
 PHONE: 610.398.0411

